

K-Sure Return Belt Carrier

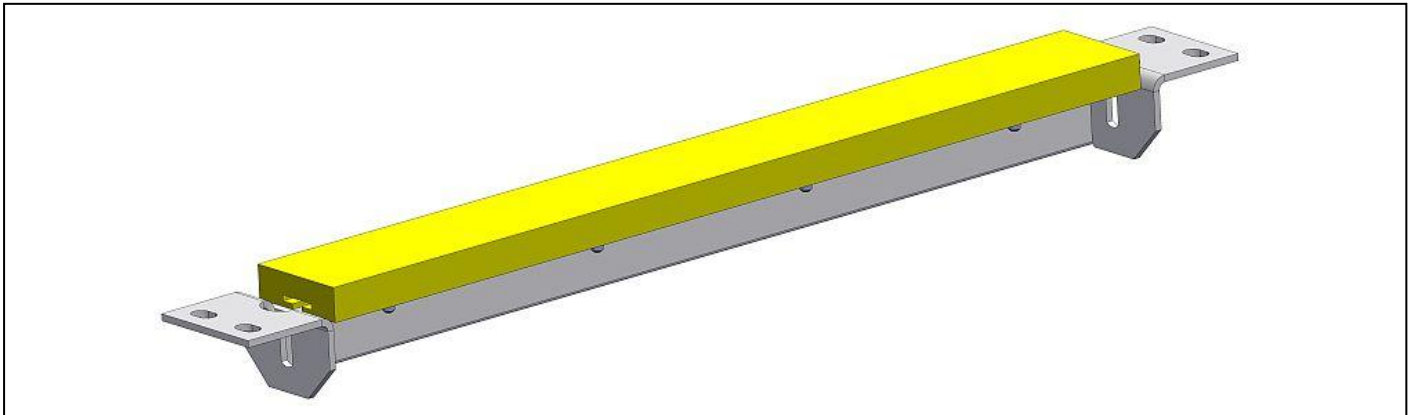

An alternative non-rotating belt support replacing a conventional return conveyor roller. Used for severe corrosive or wet applications. May also be used to dry or remove some of the material carryback.

Mounts directly into existing return bracket mounting holes. The low friction slide can be replaced.

Suitable for all belt widths up to 1200mm.

Belt Width	Centre Distance mm	Rail Length mm	Number of Bolts
540	700	550	3
500	750	600	3
600	850	700	3
650	900	750	4
750	1000	850	4
900	1150	1000	4
1050	1300	1150	5
1200	1450	1300	5

